



شجرة الحياة

TREE OF LIFE

DUBAI

BY R•EVOLUTION

YOUR HOME
YOUR TREE OF LIFE



عشاق

TREE OF LIFE

DUBAI



Energy Youthfulness Well-being Ancient knowledge

Welcome to Eywa, where luxury living meets holistic well-being. In the heart of Dubai, our exclusive community redefines opulence by integrating wellth—an unparalleled blend of wellness and wealth.

Indulge in elegantly designed apartments featuring state-of-the-art wellness amenities, including a tranquil spa, a fully equipped fitness center and serene meditation crystal gardens. Each space is crafted not just for comfort, but for a lifestyle that prioritizes your health and happiness.

At R.Evolution, we believe that true luxury is not just about material wealth; it's about cultivating a life of balance, fulfillment, and well-being. Join us in embracing a new standard of living that celebrates both your health and your lifestyle.

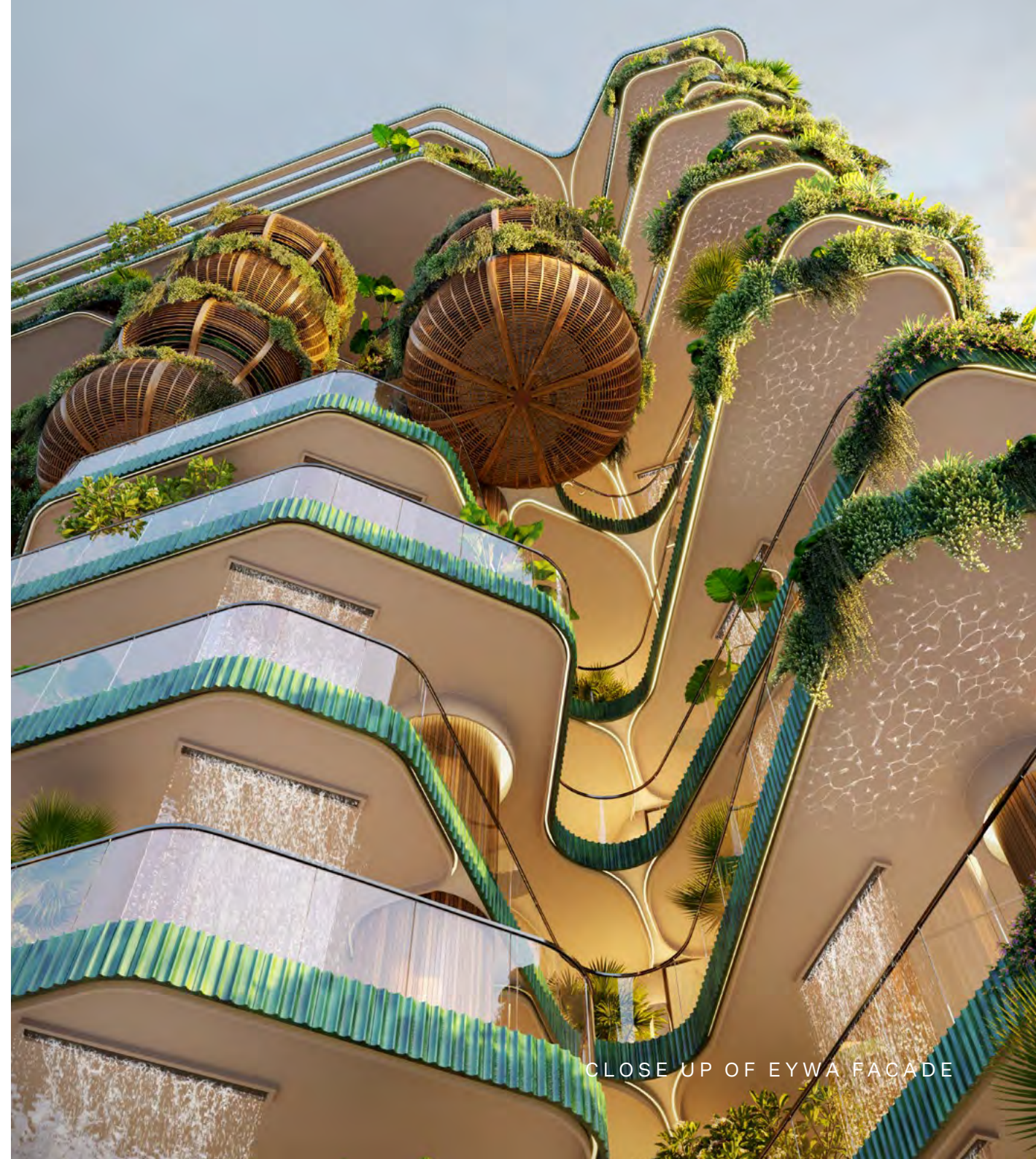

PRESS & MEDIA

We're Making Headlines!
Discover the Excitement!

Open Google

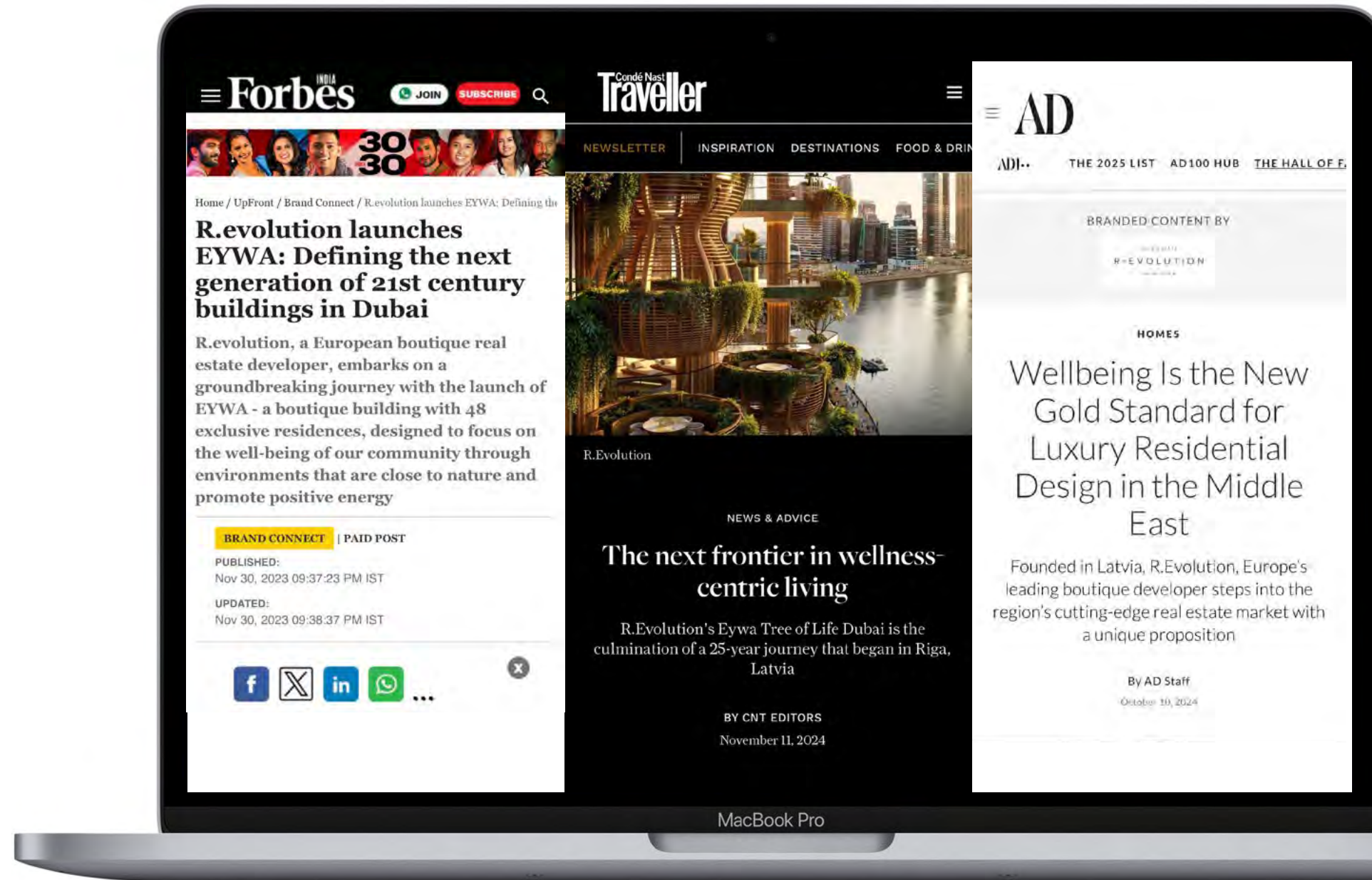



VIEW FROM THE CANAL

The Tree of Life BY R•EVOLUTION

The next revolutionary generation of the XXIst century real estate!

In essence, Eywa represents a holistic approach to personal growth and well-being, guiding you towards a life filled with positive emotions, transformative experiences, deep connections and a harmonious balance between ancient wisdom and modern advancements.

By embracing the principles of Eywa, you can embark on a journey of self-discovery, empowerment and fulfillment that enriches your life and inspires those around you.

eywa.ae



50 EXCLUSIVE WATERFRONT RESIDENCES
& 2 LUXURIOUS PENTHOUSES

—
2-5 BEDROOM (3,064 - 16,256 ft²)

APARTMENT TERRACE VIEW

26 YEARS OF
EXCELLENCE

REAL ESTATE
R • EVOLUTION
DEVELOPER

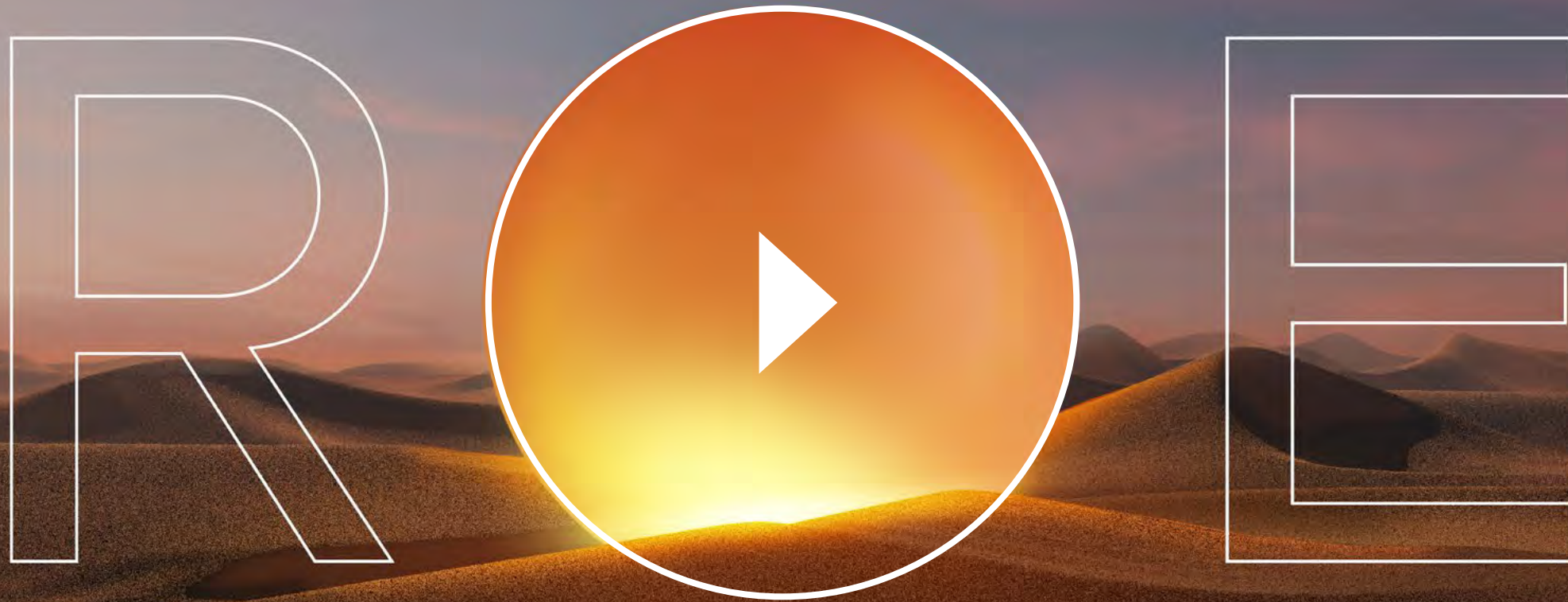

Founded in 1999

DD & Development > 2,500,000 sq ft

In development - 5,000 000 sq ft

Largest single development project - EUR 270 million

Buildings developed total GDV €500,000,000 – 600,000,000

Number of employees > 60

AWARD-WINNING PROJECTS 2023-2024



EYWA DUBAI

International Property Awards 2023-2024

WORLD'S BEST PROPERTY
BEST APARTMENT / CONDOMINIUM DEVELOPMENT
IN THE WORLD

Arabian Property Awards 2023-2024

BEST APARTMENT / CONDOMINIUM DEVELOPMENT
IN ARABIA
BEST RESIDENTIAL HIGH RISE DEVELOPMENT
IN ARABIA
BEST APARTMENT / CONDOMINIUM DEVELOPMENT
DUBAI 5 stars
BEST RESIDENTIAL HIGH RISE DEVELOPMENT
DUBAI 5 stars
RESIDENTIAL HIGH-RISE ARCHITECTURE DUBAI



BAC DE RODA

European Property Awards 2023-2024

OFFICE ARCHITECTURE AWARDS
OFFICE DEVELOPMENT AWARDS
FOR SPAIN



22PALMS

International Property Awards 2023-2024

BEST OFFICE ARCHITECTURE EUROPE
BEST OFFICE DEVELOPMENT EUROPE

European Property Awards 2023-2024

BEST OFFICE ARCHITECTURE AWARDS
BEST OFFICE DEVELOPMENT AWARDS FOR SPAIN

AWARD-WINNING PROJECTS



LEGEND.

International Property Award 2014

THE WORLD'S ARCHITECTURE MULTIPLE RESIDENCE - 1st place

European Property Awards 2014

ARCHITECTURE MULTIPLE RESIDENCE – 1st place

RESIDENTIAL DEVELOPMENT – Special jury recognition

LEISURE DEVELOPMENT – Special jury recognition

Luxury Lifestyle Awards 2014 - 1st place

Latvian Construction Industry Award 2015 - 1st place



LOFTS&ROSEGOLD

European Property Awards 2021 - Award Winner

RESIDENTIAL DEVELOPMENT LATVIA - Award Winner

RESIDENTIAL RENOVATION / REDEVELOPMENT LATVIA

- Best Mixed Use Development Latvia (5 STARS)

Luxury Lifestyle Awards 2021

BEST LUXURY MIXED USE DEVELOPMENT LATVIA - Winner



HOFT

Rethinking The Future Awards 2022 - Winner

Lifestyle Luxury Awards 2021 - Best Luxury Residential Development in Latvia

MIPIM Awards 2021

BEST RESIDENTIAL DEVELOPMENT - Finalist

Outstanding Property Award London 2021

PROPERTY DEVELOPMENT, RESIDENTIAL, MULTIPLE UNITS

- Platinum Winner

International Property Awards Europe 2021

BEST ARCHITECTURE MULTIPLY RESIDENCE LATVIA (5 STARS)

- Award Winner

RESIDENTIAL RENOVATION / REDEVELOPMENT LATVIA

- Best Residential Development Latvia (5 STARS)



TAL RESIDENCE

Luxury Lifestyle Awards 2014

- BEST NATIONAL BRAND

FIABCI Prix d'Excellence Awards 2013

- BEST RESIDENTIAL DEVELOPMENT

Spears Russia Wealth Management Award 2013

- BEST INVESTMENT PROJECT

BY R • EVOLUTION















إيوا
TREE OF LIFE

The Smallest Blue Zone on the Planet

Situated right on the largest lagoon of the Dubai Canal, Eywa offers a peaceful retreat in Business Bay, away from noisy streets and traffic. Surrounded by five-star hotels and exquisite residential developments, as well as a vibrant array of luxury restaurants and amenities, Eywa is perfectly positioned for those who seek tranquility without sacrificing convenience. Experience the beauty and serenity of Eywa—where luxury living harmonizes with the calm of nature.

LOCATION

EYWA, Marasi Drive,
Business Bay, Dubai, UAE

-  Burj Khalifa 8 min.
-  Dubai Mall 8 min.
-  Dubai Opera 8 min.
-  The Dubai Fountain 8 min.
-  Jumeirah Beach 10 min.
-  Mall of the Emirates 10 min.
-  DIFC 12 min.
-  Dubai International Airport 15 min.
-  Dubai Marina 15 min.
-  Burj Al Arab 15 min.
-  Palm Jumeirah 20 min.

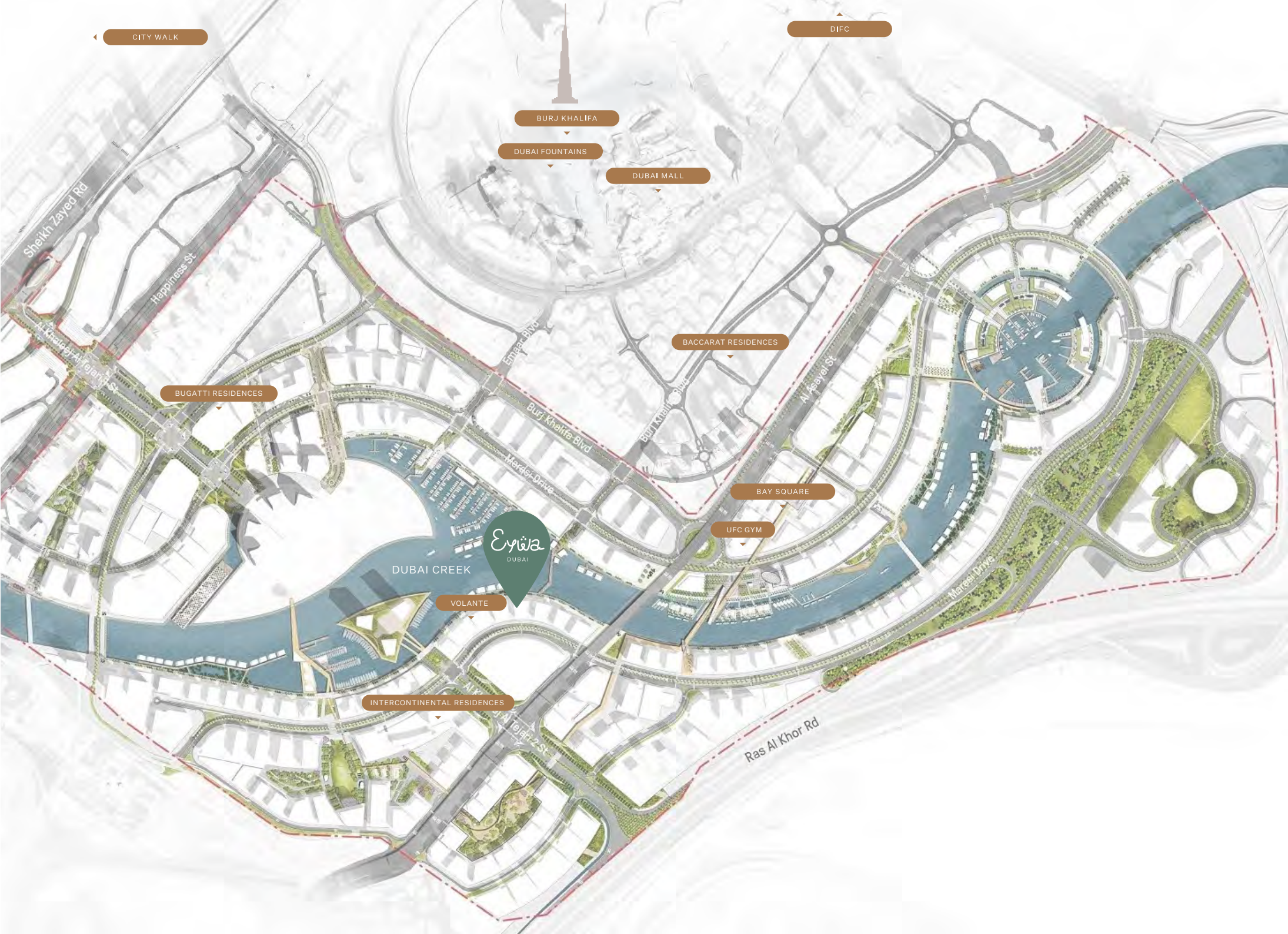



The Tree of Life BY R•EVOLUTION

Tree of Life

Strikingly unique from your very first glimpse, Eywa instantly evokes a glorious Tree of Life.

An organic canopy of branches, an enticing weave of roots, a living breathing building that represents timeless wisdom and enduring growth.

Open round columns, intertwining branches and trunks personify the Banyan tree, the Tree of Life, whose branches support our world and whose roots spread down into the underworld, a symbol of the constantly renewing and reviving world, an inexhaustible source of life.



○ —————

Architectural inspiration, banyan tree

Wellness that goes beyond

At the heart of Eywa's philosophy is a profound dedication to enhancing the well-being, health and longevity of its residents. Drawing inspiration from ancient knowledge about human nature and combining it with the latest advancements in healthcare, technology, and community development, Eywa offers a holistic approach to urban living like never before.

Each residence is a light-filled spacious haven, with floor-to-ceiling windows framing breathtaking cityscapes. Seamlessly blending contemporary design with stunning natural elements, each unit features greenery, a private pool and waterfall, and unique stone slabs, fostering a deep connection to nature.



Quality of Life BY R•EVOLUTION



APARTMENT TERRACE

eywa.de

A Manifesto for Sustainable Living & Future Lifestyle

At Eywa, our creativity and intellectual curiosity drive the development of our designs, setting us apart in refreshingly unique ways. We are excited to bring this innovative approach to life in Eywa, where thoughtful design creates a serene environment amidst the vibrant landscape of Dubai.

Within Eywa, you'll discover serene spots to relax and immerse yourself in nature. The gentle rustle of plant leaves and the soothing sound of waterfalls create an atmosphere that encourages you to be present, embracing the beauty of the "here and now" in this important moment of your life.

The Most Health Conscious & Sustainable Building on Earth

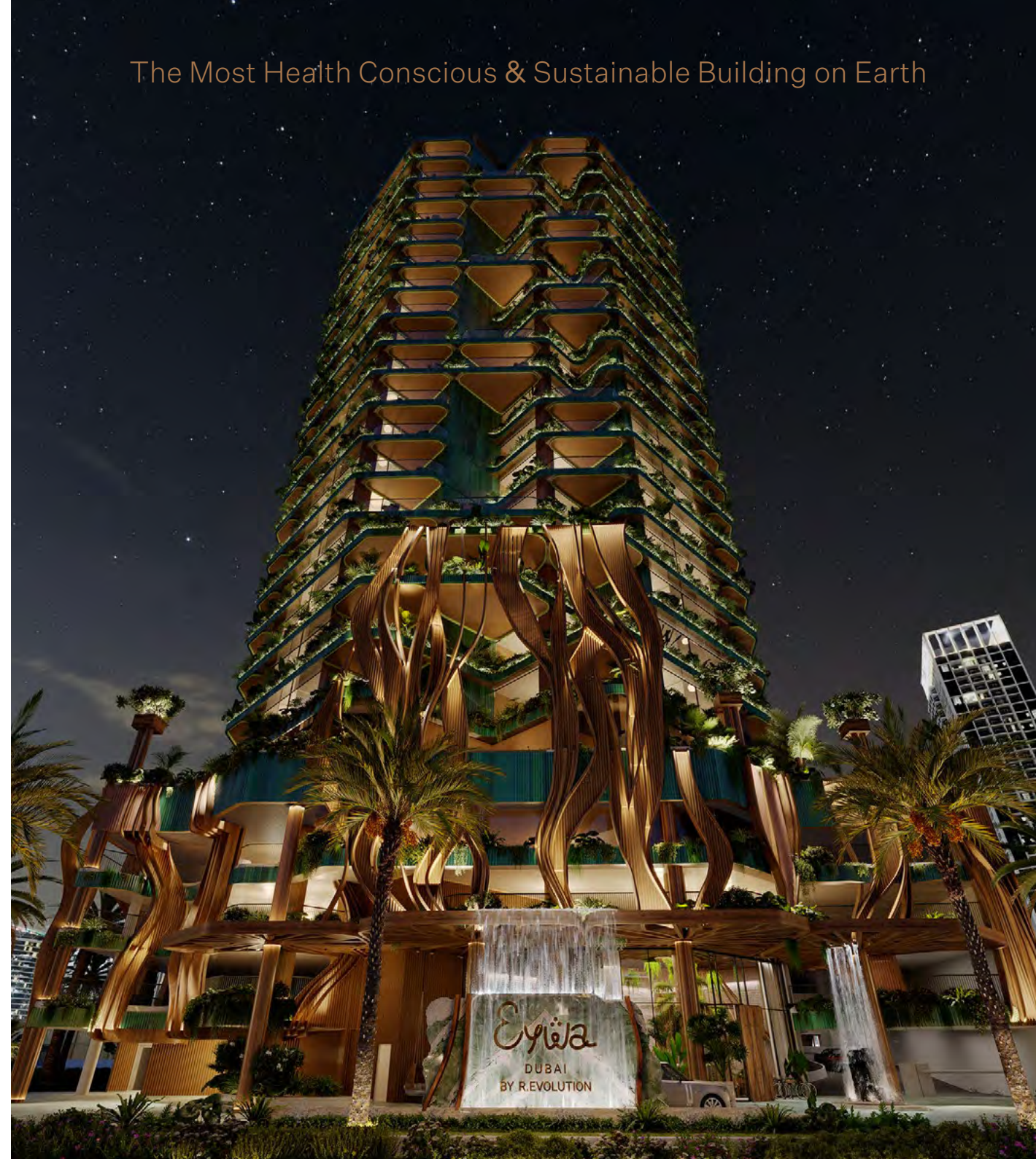

The Tree of Life BY R•EVOLUTION

eywa.ae

APARTMENT TERRACE





Promoting Health & Longevity

Eywa emphasizes the importance of holistic well-being, encompassing physical, mental, and emotional health. By adopting healthy lifestyle practices, nurturing relationships, and prioritizing self-care, you can enhance your longevity and vitality.

Imagine feeling thoroughly, unequivocally well.

Mental clarity.

Relentless energy.

Living life to the fullest.

Here at Eywa, we are committed to helping our residents to unlock their health potential – mentally and physically.

Eywa is one of a few Vastu Shastra* compliant multi storey residential buildings in the world

* Vāstu-Śāstras is an ancient science of enhancing positive and eliminating negative energies in and around a place or person; and the more positive energies are around you, the more abundance is drawn to you.

The Tree of Life BY R•EVOLUTION



A home where harmony & balance are a way of life

By incorporating crystals throughout the building, including in the foundation and the internal spaces that work together we create positive energy flow, an environment where people can thrive – mentally, physically and spiritually.

Picture a place where conflicts melt away, concentration soars, and creativity flourishes. That's what you can expect with crystals at work. Our combination of crystals scientifically designed to work together help us sharpen our minds, help us find solutions to life problems, and inspire confidence in our own decisions. Specific crystals, geodes and precious stones are placed in columns and concrete slabs from the bottom to the top of the building in a unique pyramid shape, as well as crystal gardens and Travertine floors in public areas that will work together to bring positive energy within each and every space in Eywa.



This system allows:

- to fill the building with energy,
- to clean the space from the dark manifestations of human nature,
- to reduce conflict,
- to increase concentration and ability to solve mental tasks,
- to harmonize the space for a happy life,
- to promote the development of mental and physical abilities,

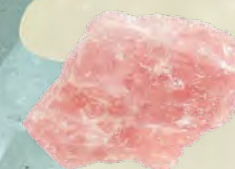
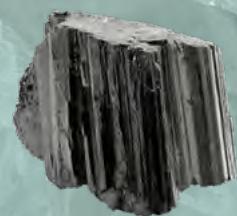

Crystals such as Selenite, Malachite, and Green Jade aren't just for show – they're powerhouses of positive energy, carefully selected to bring balance and bliss to every corner of Eywa. Our ancestors knew that the key to a happy, healthy home lies in harnessing the forces of nature. And that's exactly what we're doing. From the foundation to the rooftop, every inch of this place is infused with the wisdom of the ages.

Crystal Pyramid Within The Building

Eywa is the first and only residential building with a built-in pyramid featuring 3,355 semi-precious stones and crystals.

This unique architectural element is designed to enhance the health and increase the life expectancy of all those residing within. It helps boost focus, enhances cell regeneration and dispels conflict.

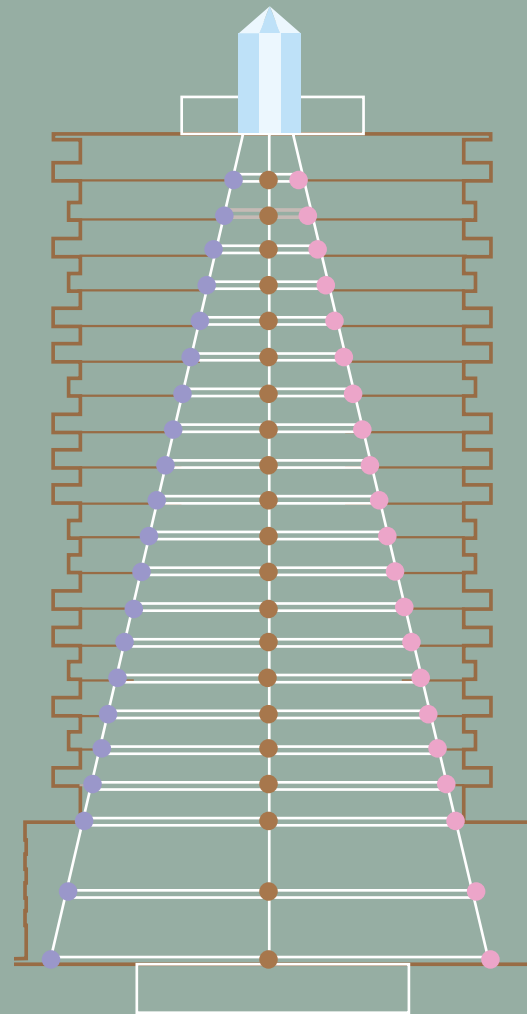

FRONT VIEW

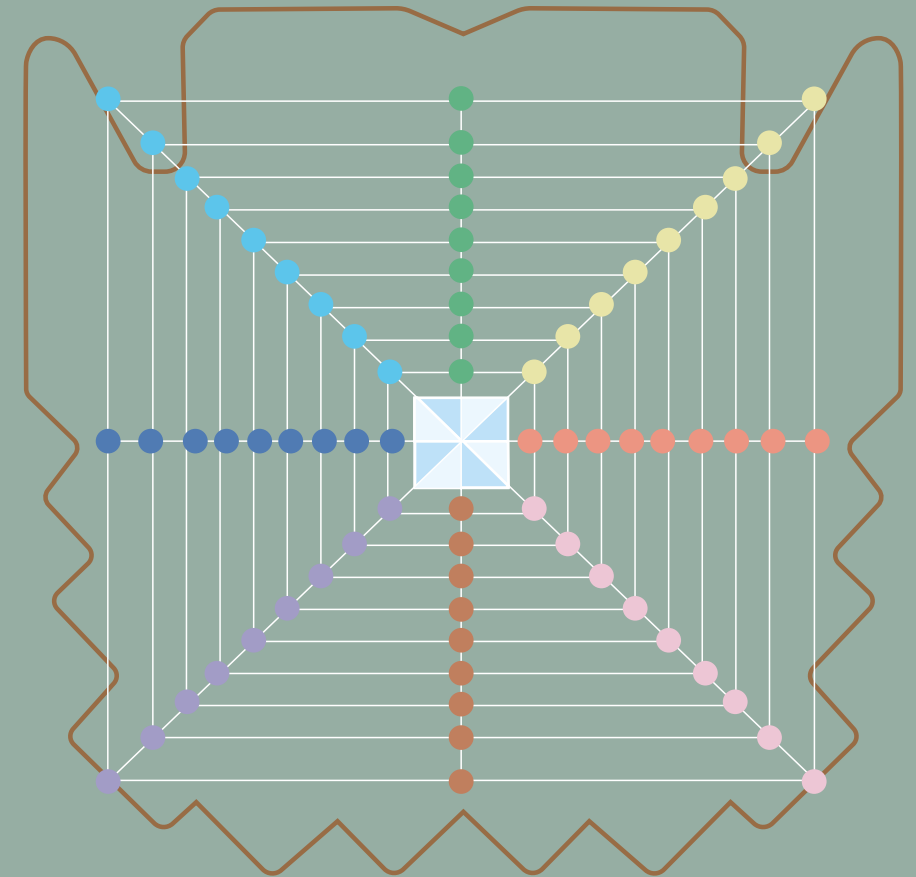

TOP VIEW

Taste

Pleasant surprises for residents, such as specially selected exclusive kinds of coffee, some treats made from natural ingredients, in the Club House and the Main Hall. The Chef's Table at the restaurant at Eywa's Apartment, where you can pre-order your favorite dishes prepared to your taste and with ingredients purchased from your list.

Smell

The air in the public places is saturated with the aroma of the Bali jungles (*ylang-ylang, jasmine, champak*) - a special fragrance created specifically for Eywa on the basis of essential oils. Blooming throughout the year trees and shrubs fill the air with a delicate aroma.

Touch

Natural rough surfaces both in interior design and in architecture, including crystals, which are recommended not only to admire, but also to touch.

SENSORIAL EXPERIENCE

Hearing

High-End acoustic systems capable of transmitting vibrations with a frequency of 432 Hz, which enhance the regeneration and soothe the body, are in the Club House, SPA, the Main Hall and Gym.

Spatial High-End 3D, 360° audio in the Main Hall helps a person to be in the here and now as the most important moment of his life. The music is chosen to harmonize energy and life in Eywa.

Light

Specially selected soft yellow light color that can be adjusted depending on the scenario, and no aggressive direct light, only hidden light sources in public areas.

Subdued base light intensity from reflected or hidden sources, both facade decorative elements and trees illumination work as reflected light sources, outdoor fireplaces and an open air cinema.

Equilibrium

Flying art objects in the atrium of the Main Hall, flying trees on the facade, waterfalls - on the facade and in some apartments, flying dining areas on the terraces in the apartments with stunning views.

Connecting with Nature Community

Eywa underscores the importance of connecting with the natural world and engaging with your community. By immersing yourself in nature, participating in community initiatives, and supporting environmental causes, you can cultivate a sense of belonging and stewardship for the planet.

SUSTAINABILITY & WELL-BEING

EYWA strongly supports green development, sustainability and anticonsumerism and, using energy efficient systems, aims to reduce energy consumption by at least 40% compared to traditional designs and standards. Only durable materials of the highest quality sourced as per LEED Platinum, WELL Platinum requirements, are used for the exterior and interior design, following our principle of anti-consumerism and contributing to the reduction of the carbon footprint.



LEED PLATINUM CERTIFICATION

LEED Certification (Leadership in Energy and Environmental Design) is the most widely used green building rating system in the world. To achieve LEED certification, a project earns points by adhering to prerequisites and credits that address carbon, energy, water, waste, transportation, materials, health and indoor environmental quality. LEED certified buildings save money, improve efficiency, lower carbon emissions and create healthier places for people.

The goal of LEED and WELL is to create better buildings that:

- Reduce contribution to global climate change
- Enhance individual human health
- Protect and restore water resources
- Protect and enhance biodiversity and ecosystem services
- Promote sustainable and regenerative material cycle
- Enhance community quality of life.

What does LEED Platinum & WELL Platinum give to you?

1. These certificates guarantee the highest and the most sustainable quality materials and technical solutions used in the building development.
2. Working in such a building brings a beneficial impact on your health and longevity: both mental and physical.
3. Utility bills are much lower than in an ordinary building due to energy efficiency and durability of the materials used.
4. There are few buildings in the world that are both LEED Platinum and WELL Platinum certified, and customer awareness of the value of such buildings is growing every year. That is why such buildings are the best investments and are the most competitive and valuable product in the real estate market even at resale.
5. You contribute to the conservation of the planet's resources and life on the Earth.

OUR PRIORITIES ARE: WELL-BEING & SUSTAINABILITY, UNITY WITH NATURE & COMMUNITY.

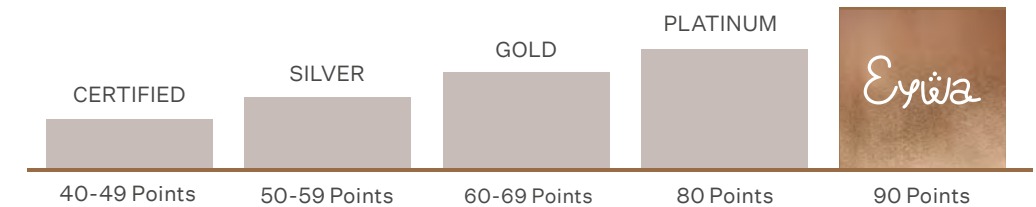

WELL PLATINUM CERTIFICATION

WELL Certification is managed and administered by the International WELL Building Institute (IWBI), a public benefit corporation whose mission is to improve human health and wellbeing through the built environment. WELL Building Standard measures attributes of buildings that impact occupant health by looking at seven factors, or Core Concepts: Air, Water, Nourishment, Light, Fitness, Comfort, Mind. WELL optimizes cognitive and emotional health through design, technology, and treatment strategies.

Material selection rooted in mindfulness & sustainability

We prioritize materials that emit positive energy and promote harmony within living spaces. Natural elements such as wood, stone, and clay are favoured for their grounding and balancing effects:

Wood: Known for its warmth and grounding properties, wood fosters a sense of connection to nature and promotes relaxation.

Stone: Revered for its stability and endurance, stone imbues spaces with a sense of resilience and strength.

Clay: With its purifying and calming qualities, clay creates environments conducive to rejuvenation and well-being.



WOOD

The natural beauty

The richness of natural and solid wood. The exotic textures of veneers give the impression of a detailed and precise drawing embracing the art of the nature.

The wood is left in its natural state, with only minimal sanding and finishing applied to protect the wood and enhance its natural beauty. The required wood tonality is achieved with tinted wax or oil.



Australian Paldao veneered
doors with hidden hinges

Multilayer oak parquet

Multilayer beech parquet

STONE

The natural beauty

We appreciate the value of materials through contrasts.
Strong, natural textures and light, fragile accents.
Soft fabric and luxurious veneer.
Natural stone pattern and neutral plaster.

Honed matt travertine tiles are used for floors in dry areas,
the pitted surface is filled with transparent epoxide. In wet
areas brushed travertine tiles are used, with a rough, slightly
uneven surface that is less slippery when wet.

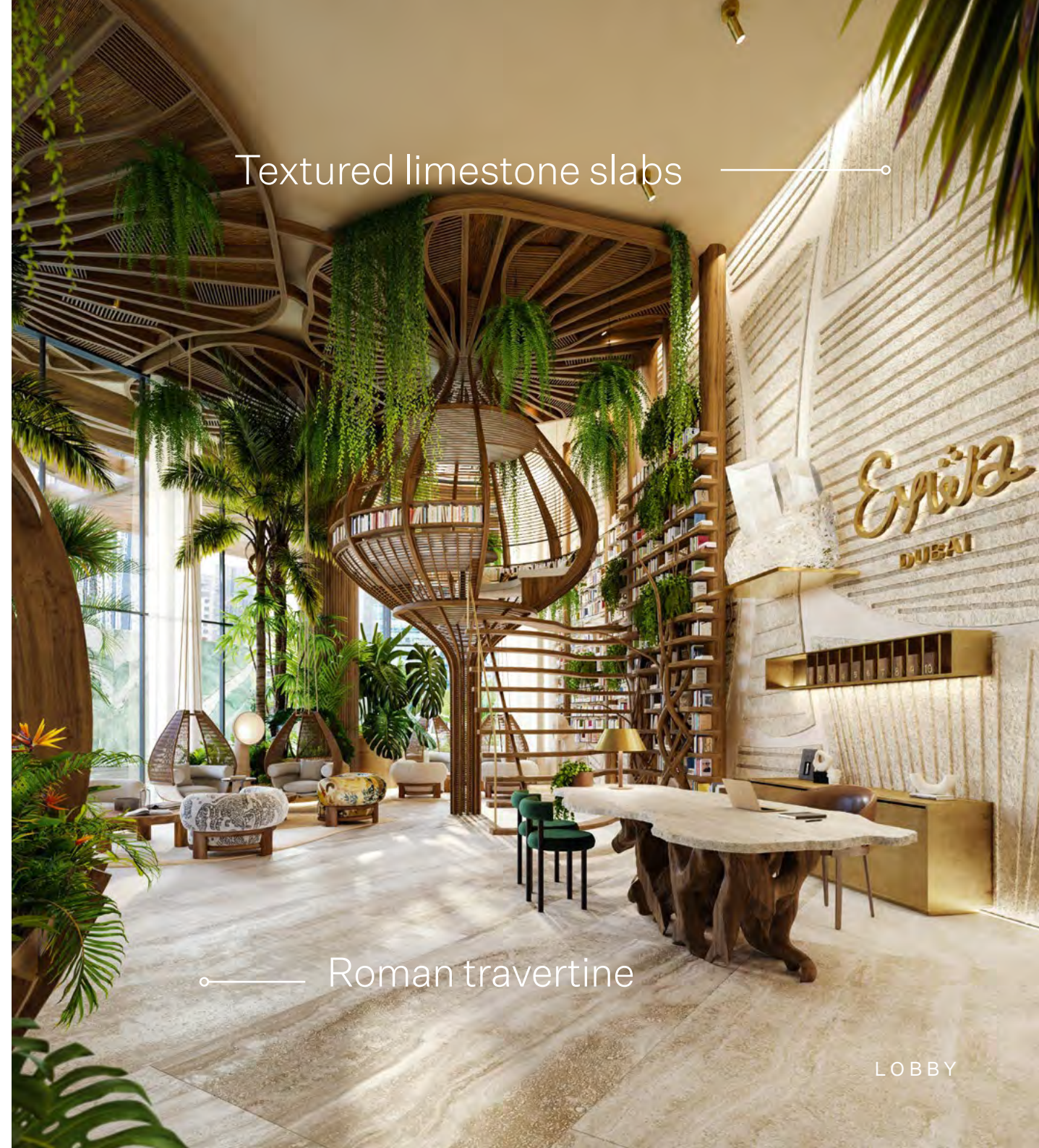

Textured limestone slabs

Roman travertine



Roman travertine



Natural stone slab

Roman travertine

BATHROOM

The Tree of Life BY R•EVOLUTION

Miele



BOSCH

LIEBHERR

- front of house kitchen- hobs,
microwave, oven, dishwasher,
extractor.

Roman travertine

Australian Paldao
veneered doors
with hidden hinges

OUR PARTNERS & COLLABORATIONS

KITCHEN APPLIANCES

BOSCH 

 **elica**

Miele

LIEBHERR

FORMANI®

lualdi FORTE MOBILI SYSTEM



RUGS

cc-tapis

TAI PING

RUGS AND CARPETS

ferm
LIVING

SANITARYWARE

 **FLAMINIA.**

 **GEBERIT**

GESSI

FRANKE



TECE 
close to you

W

NOON & CO.
ARTISAN-MADE STONE CRAFT
EST. 2005

REXA
DESIGN

LIGHTING



FLOS

LULU AND GEORGIA

VIZIA

PLUS+
PLUSTCOLLECTION

VINCENT SHEPPARD

VENTILATION

TRANE
TECHNOLOGIES

FURNITURE

Minotti

Cassina

MOROSO™

1920 R
MADE IN ITALY

saba

 **Tacchini**

porada

CB2

B&B
ITALIA

rochebobo
PARIS

Rimadesio

 **SOHO HOME**

COLLECTOR

 **Loro Piana**

APRILS FORM

 **ADORNO**

de Sede
OF SWITZERLAND

PIANCA

DEDAR
MILANO

edra

EXTETA
EXTERIOR LIVING

Gallotti&Radice

GUBI 

HC28

kettal

ligne roset®

MERIDIANI
living interiors

noom

studio
STIRLING

VONNEGUT KRAFT

TRIBÙ

IVANO REDAELLI



GIORGETTI

DEIDON

doog 
world of details

PAOLA LENTI



Elevate Your Living Experience

At Eywa, luxury and health-conscious living converge with exquisite kitchen and bathroom fixtures from Gessi and Rexa Design.

GESSI'S ORIGINI COLLECTION

With Origni, Gessi explores the emotional dimension of color, offering furnishing elements that combine to create original and personalized domestic scenarios in absolute freedom. Their commitment to functional research, material expertise, and craftsmanship results in an iconic, authentic, and timeless creative code that enhances any space.

REXA DESIGN BATHROOMS

Rexa Design reimagines the bathroom as a personal sanctuary. Focusing on sustainability and wellness, their innovative solutions allow for a tailored retreat that promotes relaxation and rejuvenation.

DISCOVER YOUR IDEAL SPACE

Ready to elevate your lifestyle? Visit the Eywa Experience Centre and see how Gessi and Rexa can transform your home into a haven of luxury and well-being.



Elevate Your Space with Luxury Dressing Rooms by Eywa

Eywa's dressing room collection embodies elegance and functionality, seamlessly integrating into luxury interiors. This sophisticated line features meticulously designed units that prioritize both aesthetics and practicality. Crafted from premium materials, including rich woods and elegant finishes, our dressing rooms provide a perfect blend of sleek lines and innovative storage solutions. Each piece is thoughtfully designed to create a serene retreat, reflecting the essence of luxury living. Eywa's commitment to craftsmanship and design excellence is evident in every detail, making this collection a standout choice for those looking to elevate their interior spaces.





Energy Principles in Architecture for Health & Longevity

Natural light: Maximizing natural light exposure enhances mood, regulates circadian rhythms, and promotes Vitamin D synthesis.

Biophilic design: Incorporating elements of nature indoors fosters psychological well-being and reduces stress.

Air quality: MERV14 filters with the possibility of natural ventilation, and non-toxic materials ensure prioritizing optimal indoor air quality, supporting respiratory health.

Water quality: Eywa combines the best that modern science has to offer: structured or activated water for drinking, water with the best pH for swimming pools and bathrooms.

FULL CYCLE FOR LONGEVITY

Physical, Mental & Emotional Health + Social connection

Lifestyle-related diseases such as obesity, diabetes, hypertension, heart attack, cancer, stroke, etc. are the leading causes of death and disability today. Prevention of these diseases (NCDs) is often significantly less costly than treatment.

Good lifestyle choices related to nutrition, physical activity, stress management, sleep, social habits and the environment are key to improved health and longevity.



PENTHOUSE YOGA ROOM

Physical & mental
well-being
go hand-in-hand

Transform Your Workout



NOHRD gym equipment combines innovative design with functionality, creating an exceptional fitness experience for home and commercial spaces. This premium collection features sleek, wooden construction that adds a touch of luxury to any environment, along with a range of customizable options to tailor workouts to individual needs. From versatile strength training systems to elegant cardio solutions, each piece is crafted with high-quality materials, ensuring durability and style. NOHRD's commitment to craftsmanship and ergonomic design makes their gym equipment a standout choice for fitness enthusiasts looking to elevate both their training and their spaces.



Discover a haven of rejuvenation in our upscale spa, boasting private massage and facial treatment rooms, as well as a luxurious beauty salon, all designed to create an unparalleled wellness experience within a prestigious setting.

Our state-of-the-art Wellness Spa is a fully-integrated part of the experience with a special program "How to improve your well-being with the help of a sauna, hammam and a cold plunge pool."

A lounge area with Faraday mesh curtains invites you to enjoy a very healthy relaxation, free from any electromagnetic waves.



Rituals Of Eywa

1. Sound Healing Session – once a week
2. Gong Ceremony “ Farewell To the Sun” – daily
3. Fire Ceremony (candles) – daily
4. Cinema Night – every Friday
5. Lectures/Masterclasses - once a week
6. Culinary Theater Performance – twice a week
7. Celebrations of the residents’ birthdays
8. Celebrations of all interational holidays



Experience a variety of flavors with our three distinct kitchens: a Vegetarian kitchen, a Vegan kitchen, and a Traditional kitchen, each designed to cater to diverse dietary preferences and promote a vibrant dining experience.

The Tree of Life BY R•EVOLUTION



In essence, Eywa is more than just a physical space - it is a philosophy, a way of life, a testament to the boundless potential of human existence. It invites individuals to dive deep into the ocean of possibilities, to embrace their true essence, and to embark on a transformative journey towards a more harmonious and enriched way of living.

EXCLUSIVE EYWA CLUB MEMBERSHIP

The Tree of Life BY R•EVOLUTION

علاقة
TREE OF LIFE

As a resident of Eywa, you gain access to our exclusive Eywa Club, designed to enhance your luxury living experience with a range of bespoke services tailored to your needs.

TAILORED SERVICES

ELEVATE YOUR LIFESTYLE

Join the Eywa Club and immerse yourself in a community that prioritizes luxury, well-being, and convenience. Experience the ultimate in exclusive living at Eywa.

- **Health & Longevity Concierge:** Enjoy personalized wellness support, from nutrition consultations to fitness planning, ensuring a holistic approach to health.
- **Resident Concierge:** Our dedicated concierge team is available to assist with everything from reservations to personal shopping, making your life effortless
- **Pet Services:** Take advantage of our pet minding and walking services, ensuring your furry friends are well cared for.
- **Shopping Services:** Enjoy convenient shopping services from Dubai and access to the waterfront market, making your daily errands effortless.
- **Vehicle Care:** Benefit from car detailing, car wash services, and refueling to keep your vehicle in pristine condition.
- **Childcare Assistance:** Access reliable childcare services to support your family's needs.
- **Laundry and Dry Cleaning:** Enjoy in-residence dry cleaning and laundry services for your convenience.
- **Emergency Repairs:** Our 24-hour emergency repair service is available for urgent maintenance needs, alongside specialized repair and maintenance solutions tailored to your requirements.
- **Transportation Services:** Utilize private transportation and limousine services for a stress-free travel experience.
- **Housekeeping:** Experience in-residence housekeeping to maintain a pristine living environment.
- **In-Residence Maintenance:** Our dedicated team is available for in-residence maintenance, ensuring your home remains in top condition.
- **While You Are Away Package:** For residents who travel frequently, we offer a turnkey maintenance package to ensure your home is impeccably maintained in your absence.

Health & Longevity Concierge Services

1. **Personalized Wellness Coordination:** Partnering with specialists to create tailored health and fitness plans.
2. **Nutritional Consultations:** Connecting clients with nutritionists for personalized meal planning.
3. **Fitness Partnerships:** Access to certified personal trainers and fitness programs.
4. **Stress Management Resources:** Facilitating workshops with mindfulness and relaxation experts.
5. **Health Assessments:** Arranging comprehensive evaluations with trusted healthcare providers.
6. **Sleep Optimization Guidance:** Referrals to sleep specialists for personalized strategies.
7. **Holistic Therapy Connections:** Access to acupuncture, massage, and alternative therapies through partner clinics.
8. **Preventive Health Services:** Coordination of regular check-ups and screenings with affiliated medical facilities.
9. **Mental Health Support Referrals:** Connecting clients with therapists and counselors for emotional well-being.
10. **Lifestyle Coaching Resources:** Partnering with wellness coaches for guidance on healthy habits.
11. **Wellness Retreat Recommendations:** Curating options for immersive health-focused retreats.
12. **Integrative Medicine Referrals:** Connecting clients with specialists in complementary and alternative therapies.
13. **Community Engagement Opportunities:** Organizing group activities and workshops in collaboration with local wellness organizations.
14. **Travel Wellness Resources:** Providing tips and referrals for maintaining health while traveling.
15. **Emergency Health Coordination:** Assisting clients in accessing medical services during emergencies.

A stylized illustration of a tree with a thick, brown trunk and branches. The leaves are represented by numerous small, brown, oval shapes. The tree is set against a solid teal background. The word "AMENITIES" is written in white, uppercase letters across the middle of the image.

AMENITIES

THE GROUND FLOOR

The Tree of Life BY R•EVOLUTION



Private Valet & Drop-Off



Double Height Lobby

Library
Teahouse
Lounge Seating



Private Service Entrance



24/7 Concierge Service

Health & Longevity Concierge
Resident Concierge



Outdoor Lounge Seating

Waterfalls



ASG Network Hub

It is a system that integrates multiple technologies and services to enhance the functionality, security, and efficiency of the building environment.

Eywa

TREE OF LIFE

DUBAI

eywa.ae



CHILDRENS PLAYGROUND

Well-Being Thrives on Harmony

Achieving a healthy work/life balance is essential for overall well-being. At our facility, we prioritize this harmony by offering versatile spaces designed to meet your needs. On the Amenities floor, you'll find private dining rooms that can easily be converted into offices or meeting rooms, providing the perfect environment for both collaboration and relaxation. Embrace a workspace that promotes balance and enhances productivity.





THE LOBBY LIBRARY

The Tree of Life BY R•EVOLUTION

Library

Often called the tree of knowledge and wisdom, the banyan tree represents growth, strength and self-awareness.

Step between the trunks of our tree, and you'll discover how Eywa celebrates, shares and nurtures knowledge.

Nestled there, within our main hall, is a community library. This features a lovingly curated collection of more than 2500 books, including a range of books from a wealth of international philosophers.

AMENITIES FLOOR

The Tree of Life BY R•EVOLUTION



3 Swimming Pools



Fitness & Wellness Studio



Wellness Spa Retreat

Sauna
Experience Showers
Hamman
Cold Plunge Pool
Faradey Mesh Cave
Ayrveda Treatment Rooms



Crystal Garden



Children's Activity Center
(Indoor & Outdoor)



Exclusive Clubhouse

Gourmet Kitchen & Dining
Business & Leisure Lounge
Library
Music Lounge
Private Dining/Meeting Rooms



Pool Deck & Bar Area



Cinema Experience
(Indoor & Outdoor)



Beauty Salon



Outdoor Gathering Lounge
(Fireplace)

4 Tribe Meeting Places

Eywa

TREE OF LIFE

DUBAI

eywa.ae

Amenities Floor Plan

The Tree of Life BY R•EVOLUTION

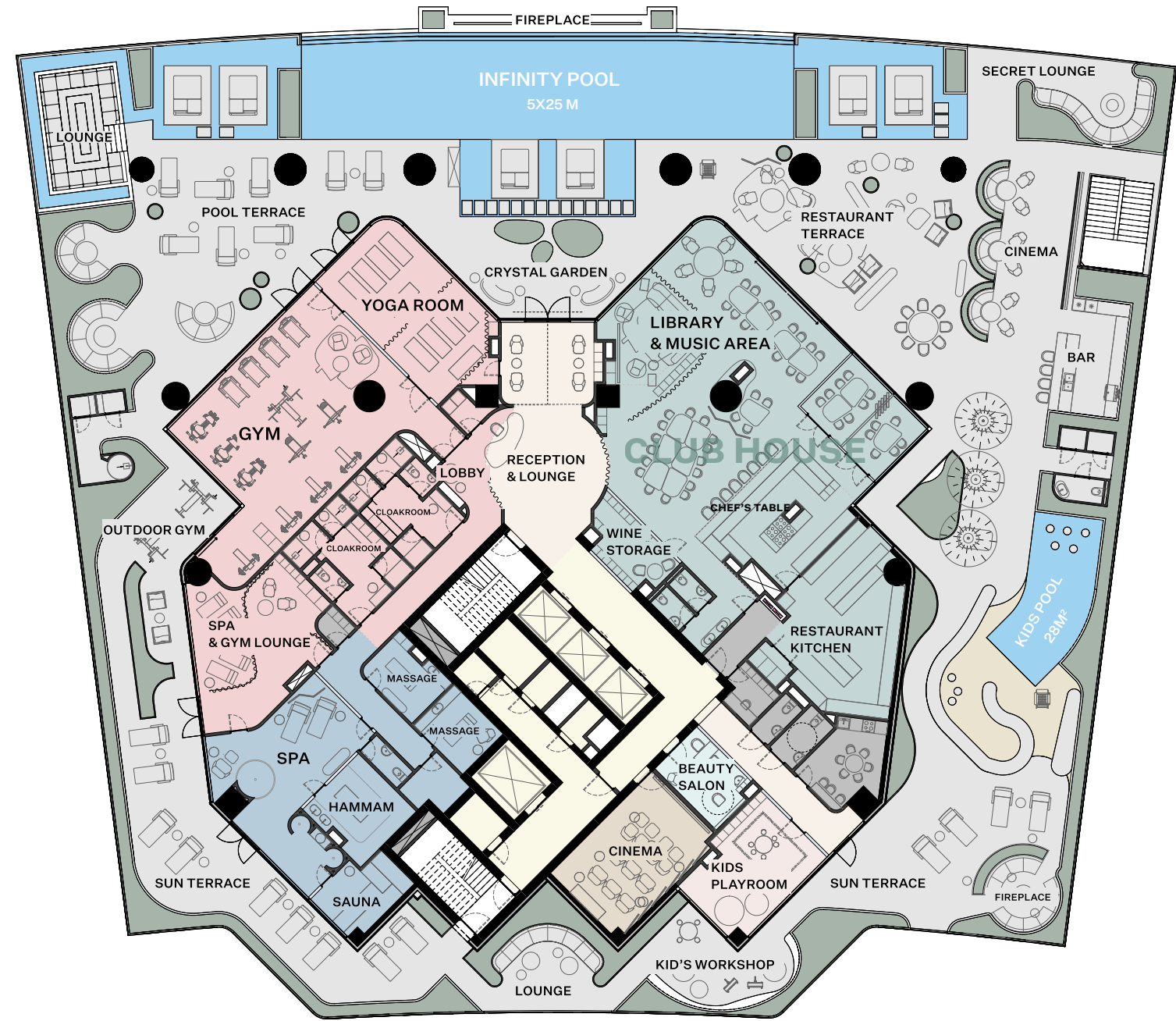

Water - The Essence of Life

Our body is like a symphony, with various resonant frequencies and interactions among cells and organs. Crystalline water serves as the backdrop for this conversation.

We transform tap water into liquid crystalline water, aligning it with the ideal frequency for bio-resonance with our cells. In Eywa, every apartment features pools and waterfalls, and the Amenity terrace boasts large pools, all filled with Alfa Omega water that continuously transmits beneficial frequencies and light. Whether you drink it, swim in it, or relax by a waterfall, Eywa ensures you benefit from these healing bio-resonance waves.

Additionally, by broadcasting heartfelt words, prayers, and soothing mantras through high-quality speakers in our water tanks and pools, we create a harmonious symphony that amplifies love and positivity, enhancing your well-being.



The Tree of Life BY R•EVOLUTION



The Tree of Life. BY R•EVOLUTION

BY

eywa.ae

POOL, RELAXATION AREA



The Tree of Life BY R•EVOLUTION



The Tree of Life BY R.EVOLUTION

eywa.ae

COMMUNITY FLOOR TERRACE



Experience convenience and leisure at our building's state-of-the-art parking facility, designed with the modern lifestyle in mind. Not only does it offer secure and spacious parking for residents, but it also features a unique lounge area for “big boys” to unwind and enjoy some friendly competition.

INNOVATIVE PARKING WITH A RECREATIONAL LOUNGE

UNITS' MIX

The Tree of Life BY R•EVOLUTION

4 apartments per floor

Floorplate levels
2, 3, 4, 5, 6, 7



3 apartments per floor

Floorplate levels
8



2 apartments per floor

Floorplate levels
14, 15, 16, 17

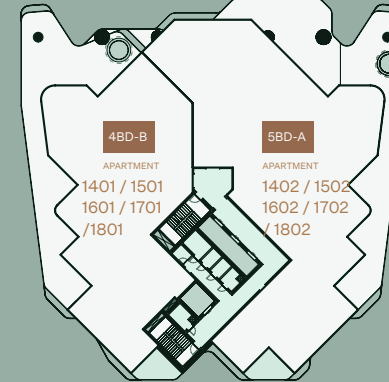

Floorplate levels
18&19

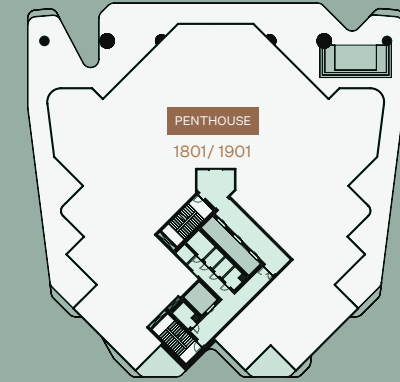

Floorplate levels
9, 10, 11, 12, 13

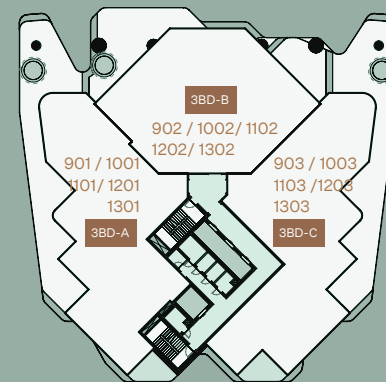

eywa

TREE OF LIFE

DUBAI

eywa.ae